

# SHEAR TEST

1/4" Dowel

Property of TENN-TEX Plastics, Inc

**Shear Test:** Amount in Pounds of Pressure applied to the Dowel before it breaks.  
**Material:** Polycarbonate

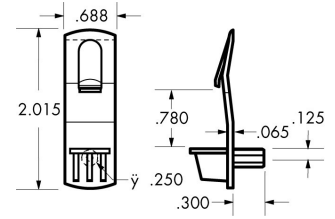
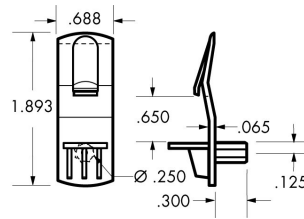
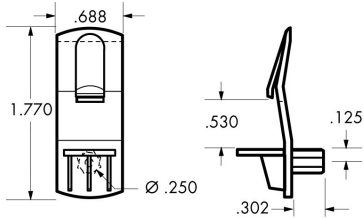

## T-600

CAVITY	#s
1	227
2	256
3	255
4	249
5	239
6	243
7	222
8	221
9	243
10	240
11	245
12	242
13	218
14	214
15	238
16	249

**AVERAGE**  
**238**

## T-601

CAVITY	#s
17	244
18	240
19	232
20	236
21	240
22	237
23	234
24	233
25	221
26	220
27	252
28	244
29	234
30	246
31	240
32	242

**AVERAGE**  
**237**

## T-602

CAVITY	#s
33	264
34	276
35	277
36	282
37	266
38	268
39	281
40	246
41	287
42	269
43	278
44	272
45	241
46	284
47	228
48	208

**AVERAGE**  
**264**

# SHEAR TEST

5 mm Dowel

Property of TENN-TEX Plastics, Inc

**Shear Test:** Amount in Pounds of Pressure applied to the Dowel before it breaks.  
**Material:** Polycarbonate

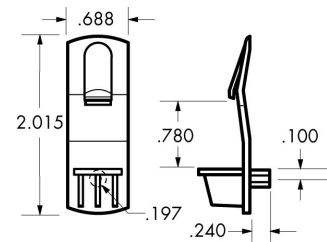
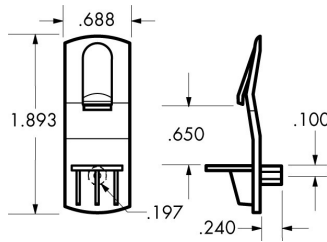
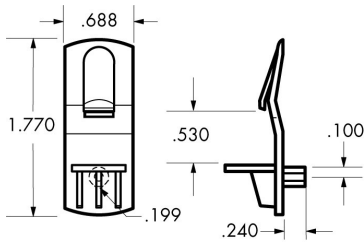

## T-800

CAVITY	#s
1	156
2	146
3	149
4	148
5	156
6	147
7	156
8	161
9	151
10	151
11	155
12	169
13	158*
14	160
15	147
16	152

**AVERAGE**  
**144**

\* No part found for this cavity, alternate part tested

## T-801

CAVITY	#s
17	162
18	171
19	170
20	170
21	164
22	169
23	171
24	184
25	171
26	165*
27	149
28	179
29	171
30	164
31	160
32	161

**AVERAGE**  
**157**

\* No part found for this cavity, alternate part tested

## T-802

CAVITY	#s
33	148
34	187
35	189
36	184
37	168
38	174
39	166
40	188
41	169
42	171
43	152
44	176
45	169
46	180
47	187
48	141

**AVERAGE**  
**172**

