

# NEW PRODUCT !

## False front connector

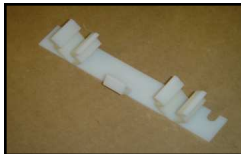

Use this easily installed 2 piece connector for any type of removable false fronts or access panels. Made from durable ABS, it can be screwed on or stapled. Stable, will not split your face frame!



**T-195 False Front FEMALE Clip**  
*(use with either T-194-00 or T-194-01)*  
 T-195 natural ABS 800 per box

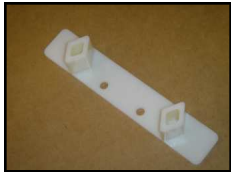

**T-194 False Front MALE Clip (min 4 1/2" opening)**  
 T-194 natural ABS 800 per box

**T-194-01 False Front MALE Clip (min 4" opening)**  
 T-194-01 natural ABS 800 per box

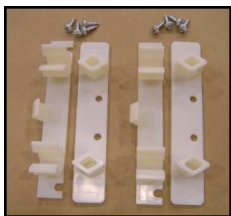

**Polybags, each will handle one false front/panel**  
*Min 4 1/2" opening*  
 B-339 2 T-194, 2 T-195, 8 screws per bag  
 50 bags per box  
*Min 4" opening*  
 B-340 2 T-194-01, 2 T-195, 8 screws per bag  
 50 bags per box

8011 National Service Road  
 P.O. Box 550  
 Colfax, NC 27235

Phone: 800-TENN-TEX  
 Fax: 336-931-1110  
 www.tenntex.com

**Screw-on or staple. A #6x 1/2" truss head screw is recommended.**

**False front bracket mounting location:**

- Side overlay + 18.5mm (0.728") for T-194 and T-194-01
- Bottom overlay + 8mm (0.315") for T-194
- Bottom overlay + 4 mm (0.157") for T-194-01

**The home of the QuikTRAY™**